

Date: March 27th 2019 Author: Ash Colfer 604 444 3732 Project: WO# NTWK# 2652982  
 Go Traffic Management: 170-8061 Lougheed Hwy, Burnaby, BC V5A 1W9 Office: 604-444-3799 Fig: 7.6  
 Dwg: 002

Comments:

Telus  
 Dean Herbert : 604 690 3678



City of Chilliwack  
 Job location: Peach Rd  
 Closure description: Southbound Parking Lane and Sidewalk Closure  
 Job description: Utility Works  
 Tentative date and hours: April 22nd - May 3rd 2019  
 Traffic Plan based on a 50 km/h speed zone  
 Traffic specifications based on the Traffic Management Manual for Work on Roadways 2015

**Notes:**  
 - Advanced Warning Sign distances may be shortened due to urban block length.  
 - TCP to assist construction vehicles ingress/ egress.  
 - 3.5m lane width to be maintained.  
 - TCP to Identify & Illustrate an escape route once on site

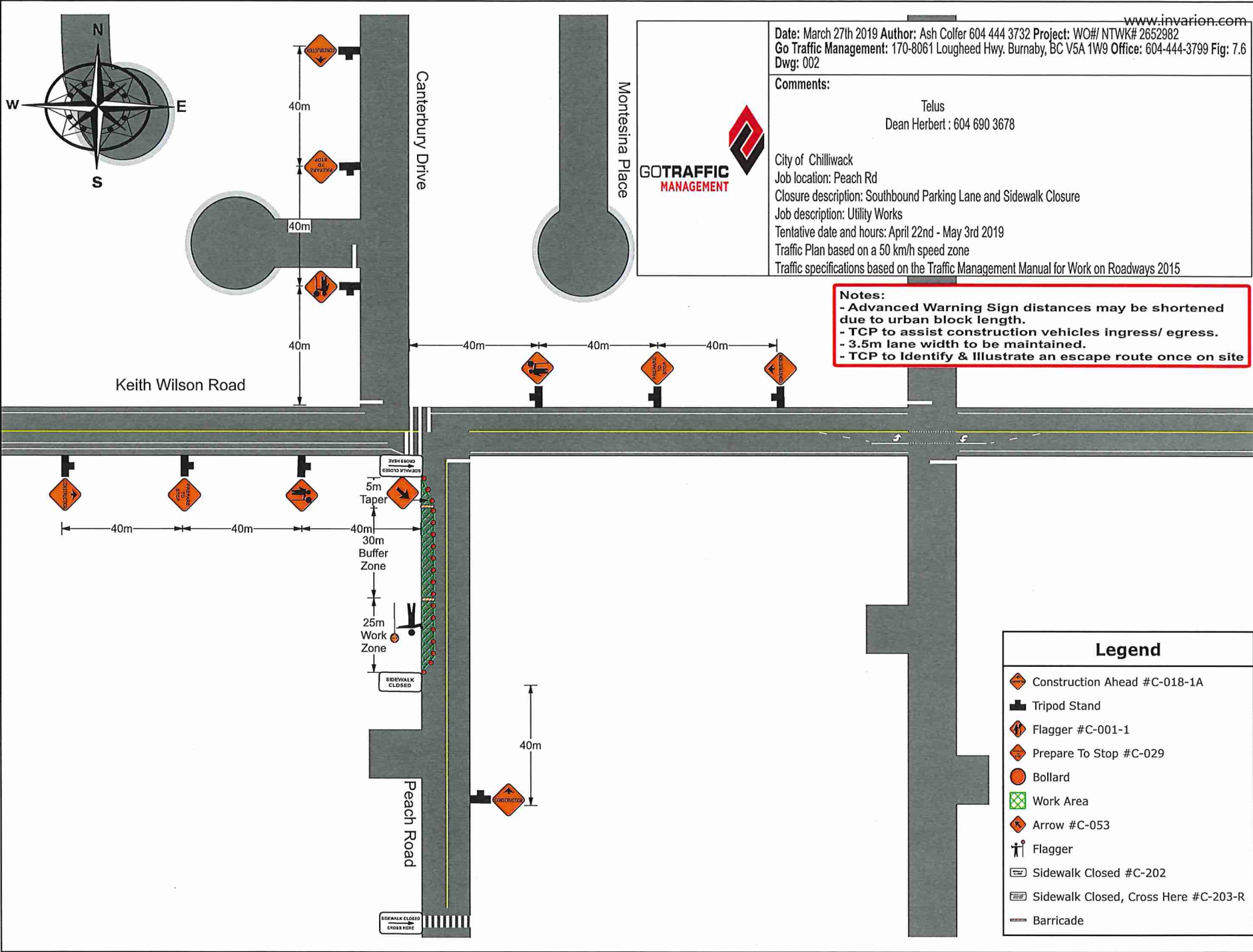

Legend	
	Construction Ahead #C-018-1A
	Tripod Stand
	Flagger #C-001-1
	Prepare To Stop #C-029
	Bollard
	Work Area
	Arrow #C-053
	Flagger
	Sidewalk Closed #C-202
	Sidewalk Closed, Cross Here #C-203-R
	Barricade

